

Product Datasheet

50 LPM Duplex Pump Set | Tank Mounted

Atlantis Product Code: PUM.DPS.T-50

Atlantis

StoraFuel Product

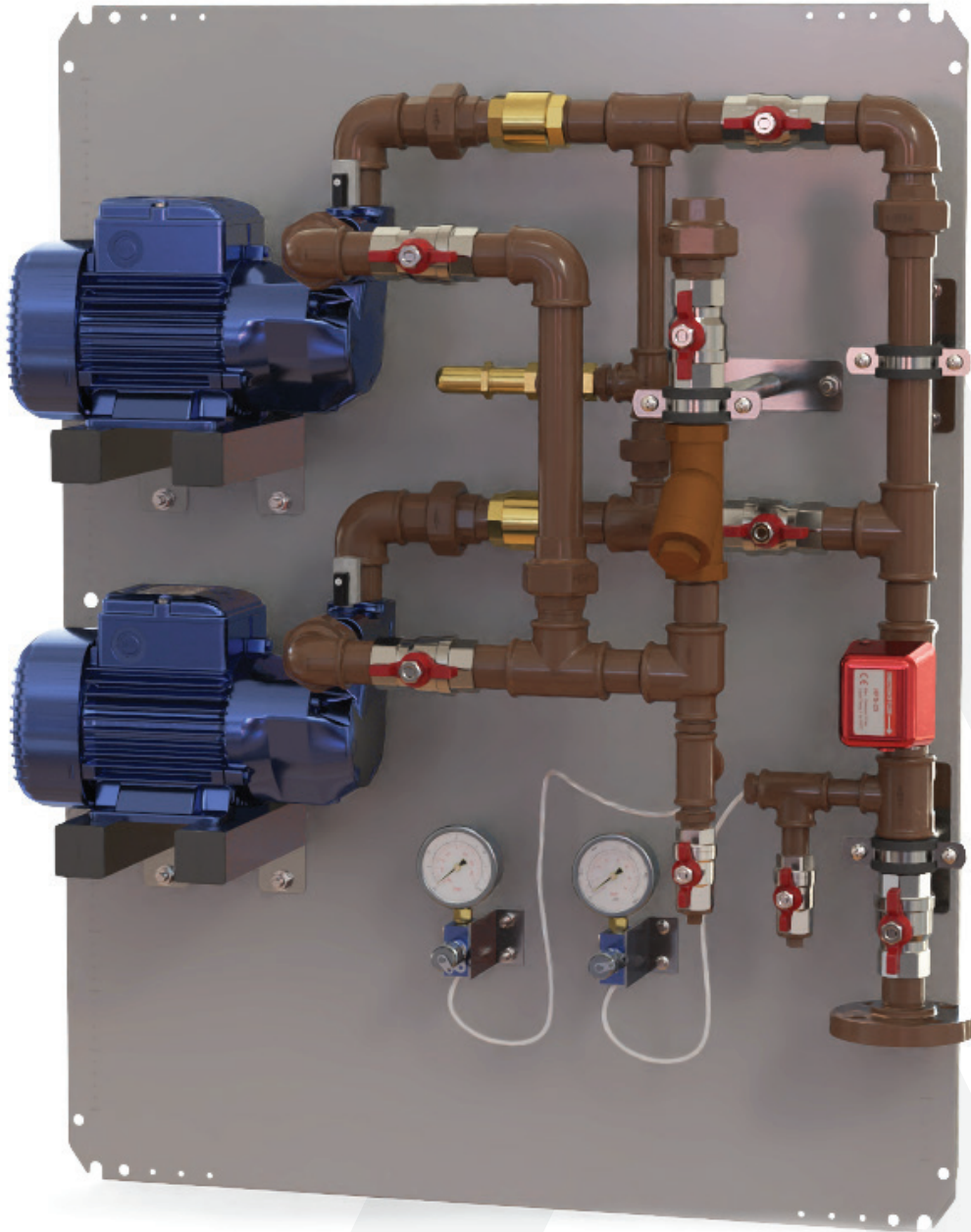

Product Datasheet

50 LPM Duplex Pump Set | Tank Mounted

Atlantis Product Code: PUM.DPS.T-50

ALTERNATING DUPLEX PUMP SET FOR TANK MOUNT

Designed for automatic fuel transfer.

Options for pump START / STOP from levels, Overpressure Switches, Float Switches, Fire alarms etc. for integration with BMS controls.

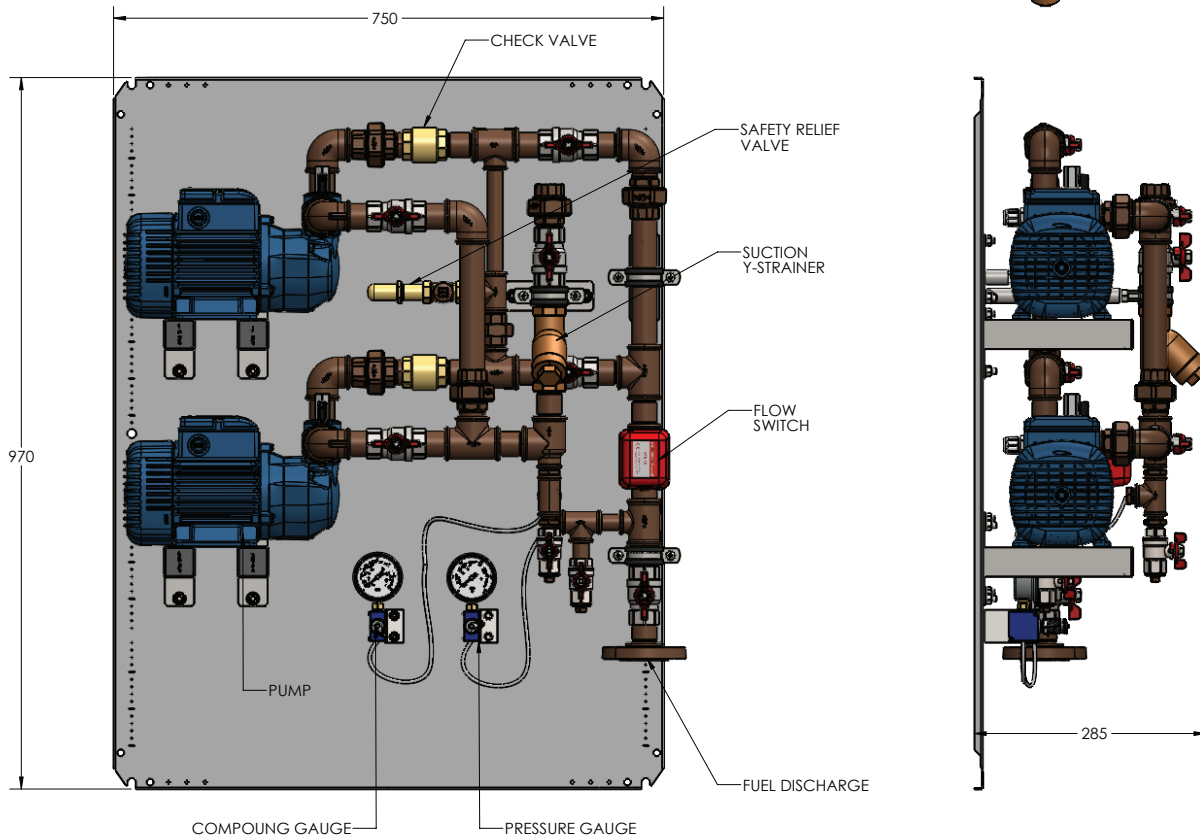
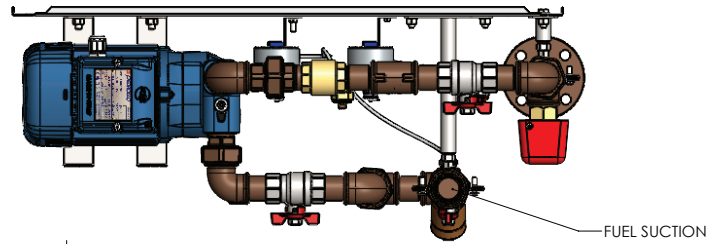

COMPONENTS

- 2 Single phase 50Hz PKm80 pumps with peripheral impeller.
- Flow rate up to 50 l/min – see next page for pump details.
- Isolator Switch.
- Mesh screen Y strainer on inlet.
- Particle counter test point.
- Pressure Relief Valve.
- Paddle Flow switch.
- Check Valves on inlet and outlets.
- Compound and Pressure Gauges.
- Isolation valves on inlet and outlets.
- Drain valves.

Control Panel mounted locally – see next page for details.

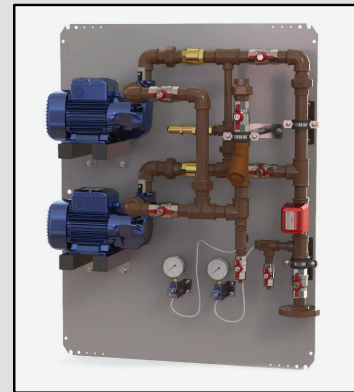

CONTROL PANEL

- Locally mounted adjacent to Fuel Pump Set.
- HAND / AUTO selector switches for Pump 1 and Pump 2 control.
- 5 volt free SPDT contacts: Safety alarm, overload relay of Pump 1, overload relay of Pump 2, level alarm and power failure.
- Panel will alarm and STOP pump if no flow or bund float switch triggered.
- TEST / OFF / AUTO switch for alarm light and buzzer.
- Top row lamps for Power, Pump 1 Running, Pump 1 Tripped, Pump 2 Running, Pump 2 Tripped & Alarm.



PUMP SPECIFICATIONS – PKm80

- Flow rate: Up to 50 l/min (3 m³/h).
- Max. working pressure: 7 bar.
- Liquid temperature: -10°C to +60°C.
- Ambient temperature: Up to +40°C.
- Motor: 0.75Kw 1HP Motor / Single phase 230 V (5.2 A) – 50 Hz with thermal overload protection.
- Continuous duty S1.

Characteristic Curves And Performance Data

50 Hz n= 2900 min⁻¹ HS (Suction height) = 0 m

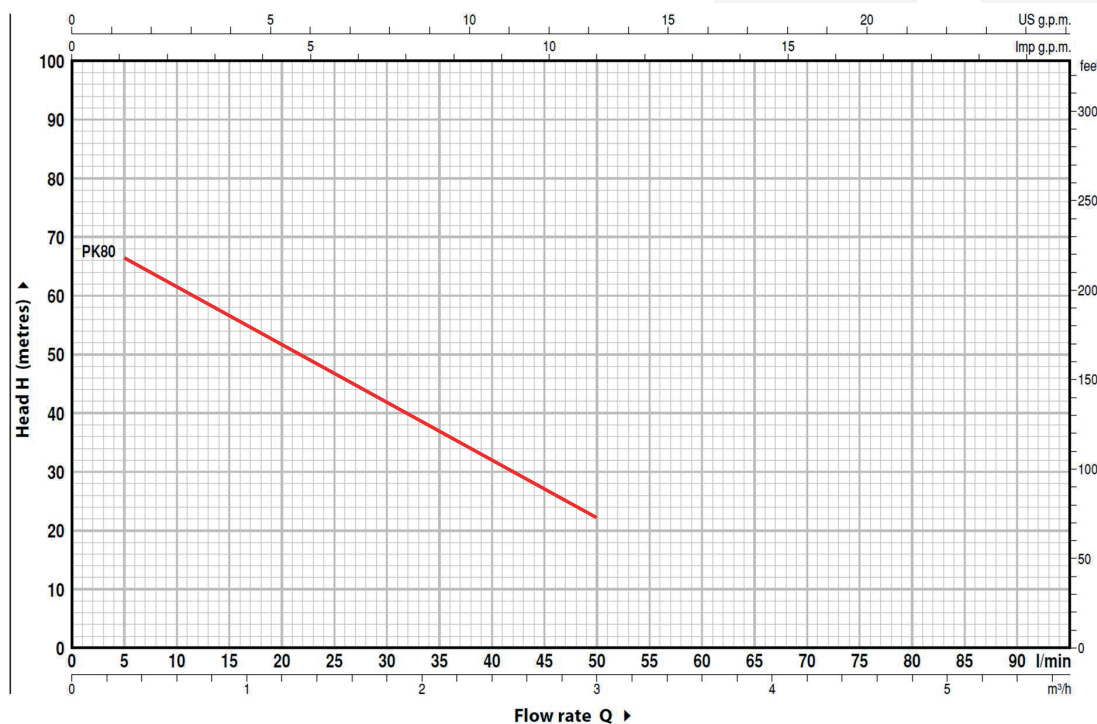

Performance Data											
Head (H)	m	70	66	61	56	51	46	41	36.5	31	22
Flow Rate (Q)	m ³ /h	0	0.3	0.6	0.9	1.2	1.5	1.8	2.1	2.4	3
	l/min	0	5	10	15	20	25	30	35	40	50